

## Strut profiles with 10 mm slot

The Rexroth modular profile system, with 10 mm slots in the modular dimensions 40 mm, 45 mm, 50 mm, and 60 mm, covers all conventional profile dimensions on the world market.

45 mm, and 50 mm, e.g. 50x50L) combine high strengths with minimum use of materials. This gives you a cost-effective and stable solution for the construction of tables, protection devices or frames, for instance.

Thanks to their computer-optimized design, the strut profiles L with 10 mm slot (modular dimensions 40 mm,

### Slot, modular dimensions, central bore

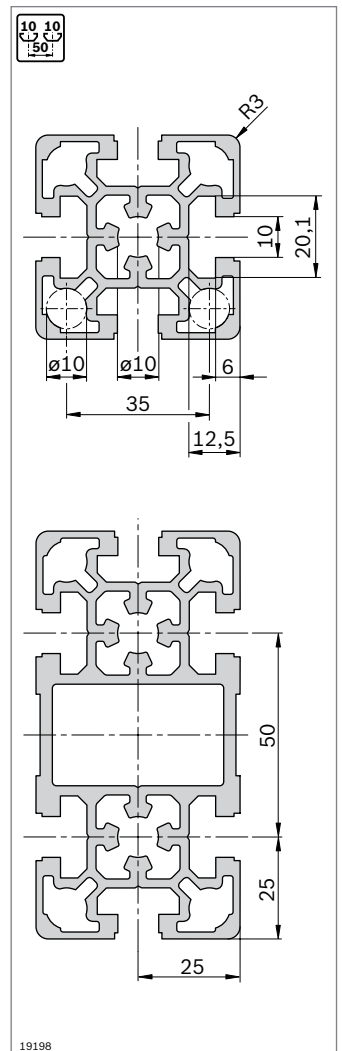
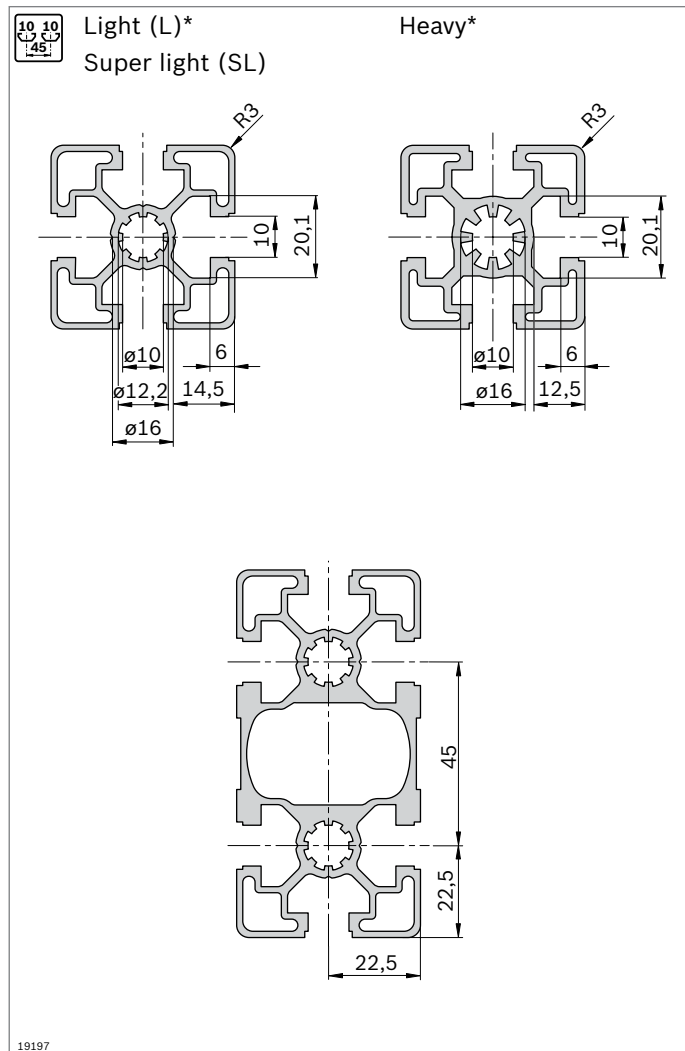
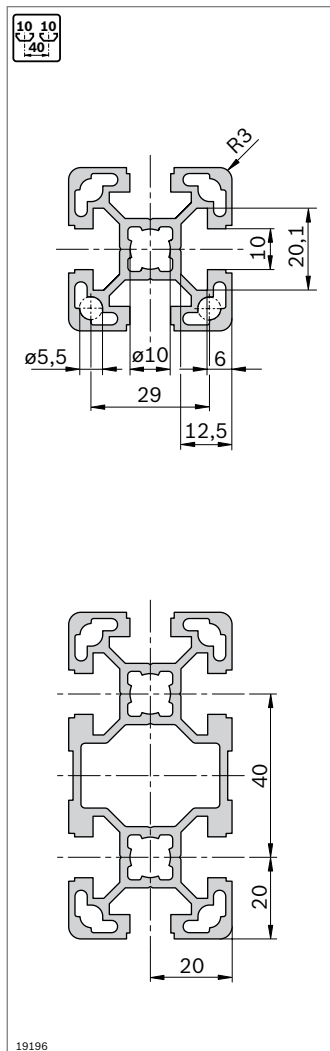

\*) The following L-profiles have a "heavy" slot geometry:  
45x90x90L; 45x90x90L 4N; 90x90L; 90x90L 4N; 90x90L 4NVS; 90x180L

**Minimum profile lengths (mm) for Quick & Easy standard profile finishing on one or both sides**

	-	M12	M16	D9.8	D17/DB17	F1
-	50	60	120	50	60	60
M12	60	110	180	90	90	110
M16	120	180	240	150	170	170
D9.8	50	90	150	80	70	90
D17/DB17	60	90	170	70	80	90
F1	60	110	170	90	90	80

For applications with high loads, we recommend especially stable profiles with 10 mm slots, e.g. for heavy work tables, fixtures, machine frames, transport shuttles, protective enclosures, and handling systems.

Due to its very sturdy design, this slot allows maximum strength connections.

**Profile finishing**

The diagram grid illustrates the following finishing methods and dimensions:

- D9.8:** Slot width  $p$ , diameter  $\phi 9.8$ , length  $p/2$ .
- D17:** Slot width  $p$ , diameter  $\phi 17$ , length  $22.5$ .
- DB17:** Slot width  $p$ , diameter  $\phi 17$ , length  $22.5$ .
- M12:** Slot width  $55$ , diameter  $\phi 12$ .
- M16-D22:** Slot width  $15.5$ , diameter  $\phi 22$ , length  $115$ .
- D28:** Slot width  $28$ , diameter  $\phi 28$ , length  $33$ .
- M16:** Slot width  $115$ , diameter  $\phi 16$ .
- LF:** Slot width  $22.5$ , diameter  $\phi 17$ .
- LF-S:** Slot width  $22.5$ , diameter  $\phi 17$ .
- F1:** Slot width  $18$ , diameter  $\phi 17$ , length  $50$ .
- F1/F1V:** Slot width  $18$ , diameter  $\phi 17$ , length  $30$ .

**40x40L**

A = 5,6 cm<sup>2</sup>  
 $I_x = 9,1 \text{ cm}^4$   
 $I_y = 9,1 \text{ cm}^4$   
 $W_x = 4,5 \text{ cm}^3$   
 $W_y = 4,5 \text{ cm}^3$   
 m = 1,5 kg/m

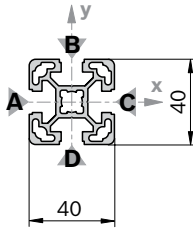

19199

Cover cap	Color	ESD	No.
40x40 (1x)	Signal gray		100 <b>3 842 548 746</b>
40x40 (1x)	Black		20 <b>3 842 548 747</b>
Material:	PP		

Cover cap with hole	Color	ESD	No.
40x40 (1x)	Signal gray		20 <b>3 842 548 782</b>
40x40 (1x)	Black		20 <b>3 842 548 783</b>
Material:	PP		

**40x40L ON**

A = 6,3 cm<sup>2</sup>  
 $I_x = 10,4 \text{ cm}^4$   
 $I_y = 10,4 \text{ cm}^4$   
 $W_x = 5,2 \text{ cm}^3$   
 $W_y = 5,2 \text{ cm}^3$   
 m = 1,7 kg/m

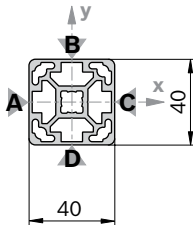

19200

Cover cap: See 40x40

**40x40L 1N**

A = 6,1 cm<sup>2</sup>  
 $I_x = 9,8 \text{ cm}^4$   
 $I_y = 10,3 \text{ cm}^4$   
 $W_x = 4,7 \text{ cm}^3$   
 $W_y = 5,1 \text{ cm}^3$   
 m = 1,7 kg/m

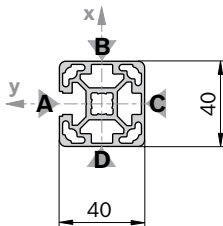

19201

Cover cap: See 40x40

40x40L	L (mm)	No.
1 pcs	50 ... 6000	<b>3 842 993 120 / L</b>
1 pcs M12	60 ... 6000	<b>3 842 993 121 / L</b>
1 pcs M12  M12	110 ... 6000	<b>3 842 993 122 / L</b>
1 pcs M12  D17	90 ... 6000	<b>3 842 993 123 / L</b>
1 pcs D17	50 ... 6000	<b>3 842 993 124 / L</b>
1 pcs D17  D17	80 ... 6000	<b>3 842 993 125 / L</b>
1 pcs D17  D17V	80 ... 6000	<b>3 842 993 126 / L</b>
1 pcs D9,8  D9,8	80 ... 6000	<b>3 842 993 129 / L</b>
20 pcs	6070	<b>3 842 529 339</b>

**Quick & Easy** (p. 2-8, see fold-out section)

40x40L	3 842 993 724 / ...
Length L (mm)	50 ... 6000
Standard profile finishing (note minimum length, p. 2-25)	M12 / D9,8 / D17 / DB17 / F1 (A) <sup>1)</sup>
Customized profile finishing (L <sub>max</sub> = 5400 mm)	DI / DIS / MT / MTS / MI / MIS / DG <sup>2)</sup>

<sup>1)</sup> For the specified slots

<sup>2)</sup> DG<sub>max</sub> = 45°; L<sub>min1</sub> / L<sub>min2</sub> = 370 / 440 mm

40x40L ON	L (mm)	No.
20 pcs	6070	<b>3 842 540 954</b>

**Quick & Easy** (p. 2-8, see fold-out section)

40x40L ON	3 842 993 760 / ...
Length L (mm)	50 ... 6000
Standard profile finishing (note minimum length, p. 2-25)	M12 / D9.8 / D17 / DB17
Customized profile finishing (L <sub>max</sub> = 5400 mm)	DI / DIS / MT / MTS / MI / MIS / DG <sup>1)</sup>

<sup>1)</sup> DG<sub>max</sub> = 45°; L<sub>min1</sub> / L<sub>min2</sub> = 370 / 440 mm

40x40L 1N	L (mm)	No.
1 pcs	50 ... 6000	<b>3 842 993 185 / L</b>
1 pcs M12  M12	110 ... 6000	<b>3 842 993 186 / L</b>
20 pcs	6070	<b>3 842 529 361</b>

**Quick & Easy** (p. 2-8, see fold-out section)

40x40L 1N	3 842 993 719 / ...
Length L (mm)	50 ... 6000
Standard profile finishing (note minimum length, p. 2-25)	M12 / D9.8 / D17 / DB17
Customized profile finishing (L <sub>max</sub> = 5400 mm)	DI / DIS / MT / MTS / MI / MIS / DG <sup>1)</sup>

<sup>1)</sup> DG<sub>max</sub> = 45°; L<sub>min1</sub> / L<sub>min2</sub> = 370 / 440 mm

**40x40L 2N**

A = 6,0 cm<sup>2</sup>  
 I<sub>x</sub> = 9,0 cm<sup>4</sup>  
 I<sub>y</sub> = 10,3 cm<sup>4</sup>  
 W<sub>x</sub> = 4,5 cm<sup>3</sup>  
 W<sub>y</sub> = 5,2 cm<sup>3</sup>  
 m = 1,6 kg/m

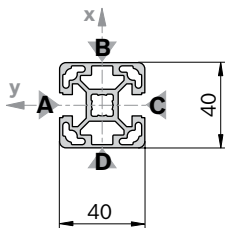

19202

Cover cap: See 40x40

40x40L 2N	L (mm)	No.
1 pcs	50 ... 6000	<b>3 842 993 187 / L</b>
1 pcs M12	110 ... 6000	<b>3 842 993 188 / L</b>
20 pcs	6070	<b>3 842 529 363</b>

**Quick & Easy** (p. 2-8, see fold-out section)

40x40L 2N	3 842 993 720 / ...
Length L (mm)	50 ... 6000
Standard profile finishing (note minimum length, p. 2-25)	M12 / D9.8 / D17 / DB17
Customized profile finishing (L <sub>max</sub> = 5400 mm)	DI / DIS / MT / MTS / MI / MIS / DG <sup>1)</sup>

<sup>1)</sup> DG<sub>max</sub> = 45°; L<sub>min1</sub> / L<sub>min2</sub> = 370 / 440 mm

**40x40L 2NVS**

A = 6,0 cm<sup>2</sup>  
 I<sub>x</sub> = 9,7 cm<sup>4</sup>  
 I<sub>y</sub> = 9,7 cm<sup>4</sup>  
 W<sub>x</sub> = 4,9 cm<sup>3</sup>  
 W<sub>y</sub> = 4,9 cm<sup>3</sup>  
 m = 1,6 kg/m

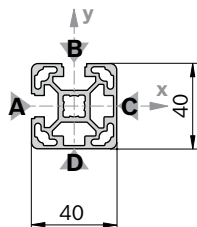

19203

Cover cap: See 40x40

40x40L 2NVS	L (mm)	No.
1 pcs	50 ... 6000	<b>3 842 993 189 / L</b>
1 pcs M12	110 ... 6000	<b>3 842 993 190 / L</b>
20 pcs	6070	<b>3 842 529 365</b>

**Quick & Easy** (p. 2-8, see fold-out section)

40x40L 2NVS	3 842 993 721 / ...
Length L (mm)	50 ... 6000
Standard profile finishing (note minimum length, p. 2-25)	M12 / D9.8 / D17 / DB17
Customized profile finishing (L <sub>max</sub> = 5400 mm)	DI / DIS / MT / MTS / MI / MIS / DG <sup>1)</sup>

<sup>1)</sup> DG<sub>max</sub> = 45°; L<sub>min1</sub> / L<sub>min2</sub> = 370 / 440 mm

**40x40L 3N**

A = 5,8 cm<sup>2</sup>  
 I<sub>x</sub> = 9,7 cm<sup>4</sup>  
 I<sub>y</sub> = 9,0 cm<sup>4</sup>  
 W<sub>x</sub> = 4,8 cm<sup>3</sup>  
 W<sub>y</sub> = 4,5 cm<sup>3</sup>  
 m = 1,6 kg/m

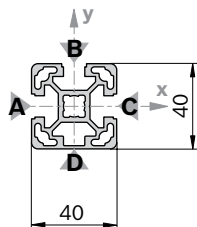

19204

Cover cap: See 40x40

40x40L 3N	L (mm)	No.
1 pcs	50 ... 6000	<b>3 842 993 191 / L</b>
1 pcs M12	110 ... 6000	<b>3 842 993 192 / L</b>
20 pcs	6070	<b>3 842 529 367</b>

**Quick & Easy** (p. 2-8, see fold-out section)

40x40L 3N	3 842 993 722 / ...
Length L (mm)	50 ... 6000
Standard profile finishing (note minimum length, p. 2-25)	M12 / D9.8 / D17 / DB17
Customized profile finishing (L <sub>max</sub> = 5400 mm)	DI / DIS / MT / MTS / MI / MIS / DG <sup>1)</sup>

<sup>1)</sup> DG<sub>max</sub> = 45°; L<sub>min1</sub> / L<sub>min2</sub> = 370 / 440 mm

**40x30°**

A = 6,2 cm<sup>2</sup>  
 $I_x = 9,4 \text{ cm}^4$   
 $I_y = 11,8 \text{ cm}^4$   
 $W_x = 4,7 \text{ cm}^3$   
 $W_y = 5,9 \text{ cm}^3$   
 m = 1,7 kg/m

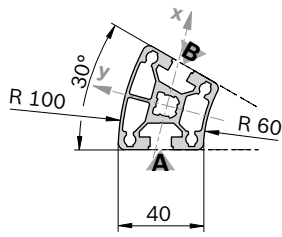

19205

Cover cap	Color	ESD	No.
40x30° (1x)	Signal gray		20 <b>3 842 551 014</b>
40x30° (1x)	Black		20 <b>3 842 551 015</b>

Material: PP

**40x45°**

A = 6,8 cm<sup>2</sup>  
 $I_x = 9,9 \text{ cm}^4$   
 $I_y = 16,6 \text{ cm}^4$   
 $W_x = 5,0 \text{ cm}^3$   
 $W_y = 8,3 \text{ cm}^3$   
 m = 1,8 kg/m

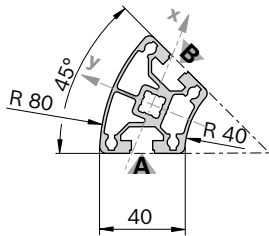

19206

Cover cap	Color	ESD	No.
40x45° (1x)	Signal gray		20 <b>3 842 551 016</b>
40x45° (1x)	Black		20 <b>3 842 551 017</b>

Material: PP

**40x60°**

A = 6,3 cm<sup>2</sup>  
 $I_x = 8,7 \text{ cm}^4$   
 $I_y = 13,1 \text{ cm}^4$   
 $W_x = 4,3 \text{ cm}^3$   
 $W_y = 6,5 \text{ cm}^3$   
 m = 1,7 kg/m

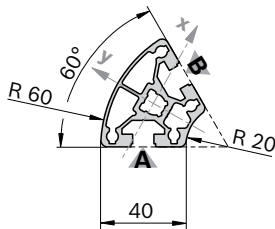

19207

Cover cap	Color	ESD	No.
40x60° (1x)	Signal gray		20 <b>3 842 551 018</b>
40x60° (1x)	Black		20 <b>3 842 551 019</b>

Material: PP

40x30°	L (mm)	No.
1 pcs	50 ... 6000	<b>3 842 993 195 / L</b>
12 pcs	6070	<b>3 842 529 371</b>

**Quick & Easy** (p. 2-8, see fold-out section)

40x30°	3 842 993 718 / ...
Length L (mm)	50 ... 6000
Standard profile finishing (note minimum length, p. 2-25)	M12
Customized profile finishing	—

40x45°	L (mm)	No.
1 pcs	50 ... 6000	<b>3 842 993 197 / L</b>
12 pcs	6070	<b>3 842 529 373</b>

**Quick & Easy** (p. 2-8, see fold-out section)

40x45°	3 842 993 726 / ...
Length L (mm)	50 ... 6000
Standard profile finishing (note minimum length, p. 2-25)	M12
Customized profile finishing	—

40x60°	L (mm)	No.
1 pcs	50 ... 6000	<b>3 842 993 198 / L</b>
12 pcs	6070	<b>3 842 529 375</b>

**Quick & Easy** (p. 2-8, see fold-out section)

40x60°	3 842 993 727 / ...
Length L (mm)	50 ... 6000
Standard profile finishing (note minimum length, p. 2-25)	M12
Customized profile finishing	—

**40x40L R**

A = 5,0 cm<sup>2</sup>  
 I<sub>x</sub> = 7,2 cm<sup>4</sup>  
 I<sub>y</sub> = 7,2 cm<sup>4</sup>  
 W<sub>x</sub> = 3,6 cm<sup>3</sup>  
 W<sub>y</sub> = 3,6 cm<sup>3</sup>  
 m = 1,3 kg/m

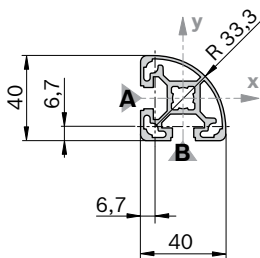

19208

Cover cap	Color	ESD	No.
40x40 R (1x)	Signal gray		20 <b>3 842 548 784</b>
40x40 R (1x)	Black		20 <b>3 842 548 785</b>

Material: PP

**40x40 HR**

A = 5,5 cm<sup>2</sup>  
 I<sub>x</sub> = 8,1 cm<sup>4</sup>  
 I<sub>y</sub> = 7,6 cm<sup>4</sup>  
 W<sub>x</sub> = 4,0 cm<sup>3</sup>  
 W<sub>y</sub> = 3,6 cm<sup>3</sup>  
 m = 1,5 kg/m

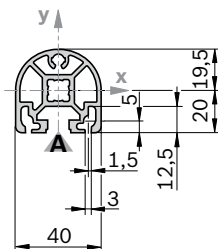

19209

Cover cap	Color	ESD	No.
40x40 HR (1x)	Signal gray		20 <b>3 842 548 786</b>
40x40 HR (1x)	Black		20 <b>3 842 548 787</b>

Material: PP

Cap with hole <sup>1)</sup>	Color	ESD	No.
40x40 HR (1x)	Signal gray		20 <b>3 842 548 786</b>
40x40 HR (1x)	Black		20 <b>3 842 548 787</b>

Material: PP

<sup>1)</sup> The cover cap is also suitable for use with a hole, which can be broken out

40x40L R	L (mm)	No.
1 pcs	50 ... 6000	<b>3 842 993 184 / L</b>
20 pcs	6070	<b>3 842 529 359</b>

**Quick & Easy** (p. 2-8, see fold-out section)

40x40L R	3 842 993 725 / ...
Length L (mm)	50 ... 6000
Standard profile finishing (note minimum length, p. 2-25)	M12 / DB17 (A,B) <sup>1)</sup>
Customized profile finishing	—

<sup>1)</sup> For the specified slots

40x40 HR	L (mm)	No.
1 pcs	50 ... 6000	<b>3 842 993 256 / L</b>
1 pcs M12	110 ... 6000	<b>3 842 993 257 / L</b>
20 pcs	6070	<b>3 842 529 381</b>

**Quick & Easy** (p. 2-8, see fold-out section)

40x40 HR	3 842 993 723 / ...
Length L (mm)	50 ... 6000
Standard profile finishing (note minimum length, p. 2-25)	M12 / DB17
Customized profile finishing (L <sub>max</sub> = 5400 mm)	DI / DIS / MT / MTS / MI / MIS / DG <sup>1)</sup>

<sup>1)</sup> DG<sub>max</sub> = 45°; L<sub>min1</sub> / L<sub>min2</sub> = 370 / 440 mm

### 40x80L

A = 9,9 cm<sup>2</sup>  
 $I_x = 63,4 \text{ cm}^4$   
 $I_y = 17,3 \text{ cm}^4$   
 $W_x = 15,9 \text{ cm}^3$   
 $W_y = 8,7 \text{ cm}^3$   
 m = 2,7 kg/m

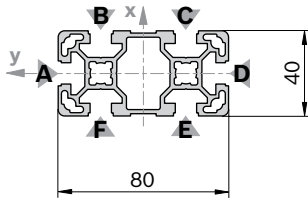

19210

Cover cap	Color	ESD	No.
40x80 (1x)	Signal gray		20 <b>3 842 548 748</b>
40x80 (1x)	Black		20 <b>3 842 548 749</b>

Material: PP

Cover cap with hole	Color	ESD	No.
40x80 (1x)	Signal gray		20 <b>3 842 548 788</b>
40x80 (1x)	Black		20 <b>3 842 548 789</b>

Material: PP

### 40x80L 2N

A = 10,9 cm<sup>2</sup>  
 $I_x = 66,6 \text{ cm}^4$   
 $I_y = 20,8 \text{ cm}^4$   
 $W_x = 16,6 \text{ cm}^3$   
 $W_y = 10,4 \text{ cm}^3$   
 m = 2,9 kg/m

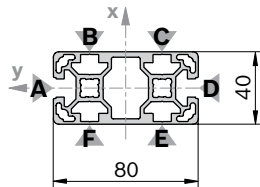

33094

Cover cap: See 40x80

### 40x80L 4N

A = 10,4 cm<sup>2</sup>  
 $I_x = 65,2 \text{ cm}^4$   
 $I_y = 19,1 \text{ cm}^4$   
 $W_x = 16,3 \text{ cm}^3$   
 $W_y = 9,9 \text{ cm}^3$   
 m = 2,8 kg/m

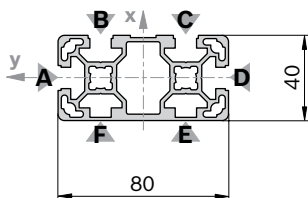

19211

Cover cap: See 40x80

40x80L	L (mm)	No.
1 pcs	50 ... 6000	<b>3 842 993 130 / L</b>
1 pcs M12	60 ... 6000	<b>3 842 993 131 / L</b>
1 pcs M12	110 ... 6000	<b>3 842 993 132 / L</b>
1 pcs D17	80 ... 6000	<b>3 842 993 135 / L</b>
1 pcs D17	80 ... 6000	<b>3 842 993 136 / L</b>
1 pcs D17V	60 ... 6000	<b>3 842 993 137 / L</b>
1 pcs D17V	80 ... 6000	<b>3 842 993 138 / L</b>
12 pcs	6070	<b>3 842 529 341</b>

Profile finishing: M12: in all core holes  
 D17: in slots B/F, C/E  
 D17V: in slots A/D

Quick & Easy (p. 2-8, see fold-out section)

40x80L	3 842 993 728 / ...
Length L (mm)	50 ... 6000
Standard profile finishing (note minimum length, p. 2-25)	M12 / D9.8 / D17 / DB17 / F1 (A,D) <sup>1)</sup>
Customized profile finishing (L <sub>max</sub> = 5400 mm)	DI / DIS / MT / MTS / MI / MIS / DG <sup>2)</sup>

<sup>1)</sup> For the specified slots

<sup>2)</sup> DG<sub>max</sub> = 45°; L<sub>min1</sub> / L<sub>min2</sub> = 439 / 578 mm

40x80L 2N	L (mm)	No.
12 pcs	6070	<b>3 842 555 650</b>

Quick & Easy (p. 2-8; see fold-out section)

40x80L 2N	3 842 993 768 / ...
Length L (mm)	50 ... 6000
Standard profile finishing (note minimum length, p. 2-25)	M12 / D9.8 / D17 / DB17 / F1 (A,D) <sup>1)</sup>
Customized profile finishing (L <sub>max</sub> = 5400 mm)	DI / DIS / MT / MTS / MI / MIS / DG <sup>2)</sup>

<sup>1)</sup> For the specified slots

<sup>2)</sup> DG<sub>max</sub> = 45°; L<sub>min1</sub> / L<sub>min2</sub> = 439 / 578 mm

40x80L 4N	L (mm)	No.
1 pcs	50 ... 6000	<b>3 842 993 424 / L</b>
12 pcs	6070	<b>3 842 536 484</b>

Quick & Easy (p. 2-8, see fold-out section)

40x80L 4N	3 842 993 729 / ...
Length L (mm)	50 ... 6000
Standard profile finishing (note minimum length, p. 2-25)	M12 / D9.8 / D17 / DB17 / F1 (A,D) <sup>1)</sup>
Customized profile finishing (L <sub>max</sub> = 5400 mm)	DI / DIS / MT / MTS / MI / MIS / DG <sup>2)</sup>

<sup>1)</sup> For the specified slots

<sup>2)</sup> DG<sub>max</sub> = 45°; L<sub>min1</sub> / L<sub>min2</sub> = 439 / 578 mm

**40x80L 2NVS**

A = 10,7 cm<sup>2</sup>  
 I<sub>x</sub> = 67,8 cm<sup>4</sup>  
 I<sub>y</sub> = 19,0 cm<sup>4</sup>  
 W<sub>x</sub> = 17,0 cm<sup>3</sup>  
 W<sub>y</sub> = 9,5 cm<sup>3</sup>  
 m = 2,9 kg/m

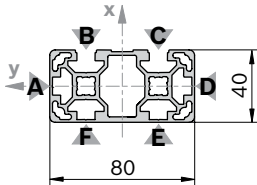

33093

Cover cap: See 40x80

<b>40x80L 2NVS</b>		L (mm)	No.
	12 pcs	6070	<b>3 842 555 649</b>

**Quick & Easy** (p. 2-8; see fold-out section)

<b>40x80 L 2NVS</b>		<b>3 842 993 767 / ...</b>	
Length L (mm)	50 ... 6000		
Standard profile finishing (note minimum length, p. 2-25)	M12 / D9.8 / D17 / DB17		
Customized profile finishing (L <sub>max</sub> = 5400 mm)	DI / DIS / MT / MTS / MI / MIS / DG <sup>1)</sup>		

<sup>1)</sup> DG<sub>max</sub> = 45°; L<sub>min1</sub> / L<sub>min2</sub> = 439 / 578 mm

**40x80L 3NVS**

A = 10,6 cm<sup>2</sup>  
 I<sub>x</sub> = 67,8 cm<sup>4</sup>  
 I<sub>y</sub> = 19,0 cm<sup>4</sup>  
 W<sub>x</sub> = 17,0 cm<sup>3</sup>  
 W<sub>y</sub> = 9,5 cm<sup>3</sup>  
 m = 2,9 kg/m

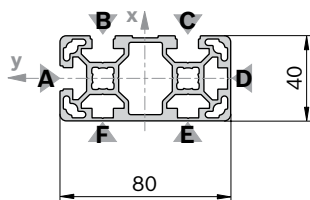

19212

Cover cap: See 40x80

<b>40x80L 3NVS</b>		L (mm)	No.
	1 pcs	50 ... 6000	<b>3 842 993 654 / L</b>
	12 pcs	6070	<b>3 842 538 330</b>

**Quick & Easy** (p. 2-8; see fold-out section)

<b>40x80L 3NVS</b>		<b>3 842 993 753 / ...</b>	
Length L (mm)	50 ... 6000		
Standard profile finishing (note minimum length, p. 2-25)	M12 / D9.8 / D17 / DB17		
Customized profile finishing (L <sub>max</sub> = 5400 mm)	DI / DIS / MT / MTS / MI / MIS / DG <sup>1)</sup>		

<sup>1)</sup> DG<sub>max</sub> = 45°; L<sub>min1</sub> / L<sub>min2</sub> = 439 / 578 mm

**40x80x80L**

A = 15,4 cm<sup>2</sup>  
 I<sub>x</sub> = 96,6 cm<sup>4</sup>  
 I<sub>y</sub> = 96,6 cm<sup>4</sup>  
 W<sub>x</sub> = 24,2 cm<sup>3</sup>  
 W<sub>y</sub> = 24,2 cm<sup>3</sup>  
 m = 4,2 kg/m

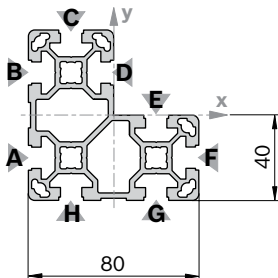

19213

<b>40x80x80L</b>		L (mm)	No.
	1 pcs	50 ... 6000	<b>3 842 993 193 / L</b>
	8 pcs	6070	<b>3 842 537 827</b>

**Quick & Easy** (p. 2-8; see fold-out section)

<b>40x80x80L</b>		<b>3 842 993 730 / ...</b>	
Length L (mm)	50 ... 6000		
Standard profile finishing (note minimum length, p. 2-25)	M12 / D9.8 / D17 / DB17		
Customized profile finishing (L <sub>max</sub> = 5400 mm)	DI / DIS / MT / MTS / MI / MIS / DG <sup>1)</sup>		

<sup>1)</sup> DG<sub>max</sub> = 45°; L<sub>min1</sub> / L<sub>min2</sub> = 439 / 578 mm

Cover cap	Color	ESD		No.
<b>40x80x80 (1x)</b>	Signal gray		20	<b>3 842 548 790</b>
<b>40x80x80 (1x)</b>	Black		20	<b>3 842 548 791</b>

Material: PP



### 40x120L

A = 15,5 cm<sup>2</sup>  
 $I_x = 203,2 \text{ cm}^4$   
 $I_y = 27,8 \text{ cm}^4$   
 $W_x = 33,9 \text{ cm}^3$   
 $W_y = 13,9 \text{ cm}^3$   
 m = 4,2 kg/m

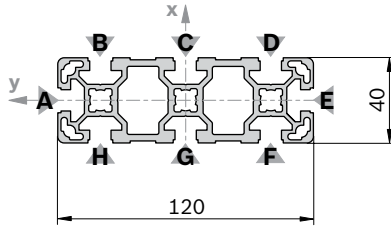

19214

Cover cap	Color	ESD	No.
40x40 (1x)	Signal gray		100 <b>3 842 548 746</b>
40x80 (1x)	Signal gray		20 <b>3 842 548 748</b>
40x40 (1x)	Black		20 <b>3 842 548 747</b>
40x80 (1x)	Black		20 <b>3 842 548 749</b>

Material: PP

#### Note:

For the 40x120L profile you require the following combination of cover caps: 1x 40x40 and 1x 40x80

### 40x160L

A = 20,5 cm<sup>2</sup>  
 $I_x = 466,7 \text{ cm}^4$   
 $I_y = 37,2 \text{ cm}^4$   
 $W_x = 58,3 \text{ cm}^3$   
 $W_y = 18,6 \text{ cm}^3$   
 m = 5,5 kg/m

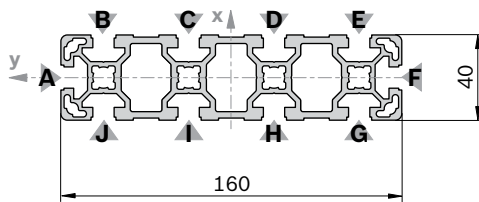

19215

Cover cap	Color	ESD	No.
40x80 (2x)	Signal gray		20 <b>3 842 548 748</b>
40x80 (2x)	Black		20 <b>3 842 548 749</b>

Material: PP

40x120L	L (mm)	No.
1 pcs	50 ... 6000	<b>3 842 993 139 / L</b>
1 pcs M12	60 ... 6000	<b>3 842 993 140 / L</b>
1 pcs M12  M12	110 ... 6000	<b>3 842 993 141 / L</b>
1 pcs D17  D17	80 ... 6000	<b>3 842 993 142 / L</b>
1 pcs D17V  D17V	90 ... 6000	<b>3 842 993 225 / L</b>
8 pcs	6070	<b>3 842 537 824</b>

Profile finishing: M12: in all core holes  
 D17: in slots B/H, C/G, D/F  
 D17V: in slots A/E

#### Quick & Easy (p. 2-8, see fold-out section)

40x120L	3 842 993 716 / ...
Length L (mm)	50 ... 6000
Standard profile finishing (note minimum length, p. 2-25)	M12 / D9.8 (B,C,D,F, G,H) <sup>1)</sup> / D17 (B,C,D,F, G,H) <sup>1)</sup> / DB17 / F1 (A,E) <sup>1)</sup>
Customized profile finishing (L <sub>max</sub> = 5400 mm)	DI / DIS / MT / MTS / MI / MIS / DG <sup>2)</sup>

<sup>1)</sup> For the specified slots

<sup>2)</sup> DG<sub>max</sub> = 45°; L<sub>min1</sub> / L<sub>min2</sub> = 439 / 578 mm

40x160L	L (mm)	No.
1 pcs	50 ... 6000	<b>3 842 993 143 / L</b>
1 pcs M12	60 ... 6000	<b>3 842 993 144 / L</b>
1 pcs M12  M12	110 ... 6000	<b>3 842 993 145 / L</b>
1 pcs D17  D17	80 ... 6000	<b>3 842 993 146 / L</b>
6 pcs	6070	<b>3 842 529 345</b>

Profile finishing: M12: in all core holes  
 D17: in slots B/J, C/I, D/H, E/G

#### Quick & Easy (p. 2-8, see fold-out section)

40x160L	3 842 993 717 / ...
Length L (mm)	80 ... 6000
Standard profile finishing (note minimum length, p. 2-25)	M12 / D9.8 (B,C,D,E,G,H, I,J) <sup>1)</sup> / D17 (B,C,D,E,G,H, I,J) <sup>1)</sup> / DB17 / F1 (A,F) <sup>1)</sup>
Customized profile finishing (L <sub>max</sub> = 5400 mm)	DI / DIS / MT / MTS / MI / MIS / DG <sup>2)</sup>

<sup>1)</sup> For the specified slots

<sup>2)</sup> DG<sub>max</sub> = 45°; L<sub>min1</sub> / L<sub>min2</sub> = 439 / 578 mm

**80x80L**

A = 18,2 cm<sup>2</sup>  
 I<sub>x</sub> = 132,1 cm<sup>4</sup>  
 I<sub>y</sub> = 132,1 cm<sup>4</sup>  
 W<sub>x</sub> = 33,0 cm<sup>3</sup>  
 W<sub>y</sub> = 33,0 cm<sup>3</sup>  
 m = 4,9 kg/m

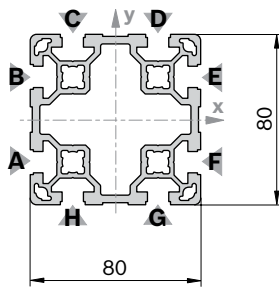

19216

Cover cap	Color	ESD		No.
80x80 (1x)	Signal gray			20 <b>3 842 548 750</b>
80x80 (1x)	Black			20 <b>3 842 548 751</b>

Material: PP

80x80L	L (mm)	No.
1 pcs	50 ... 6000	<b>3 842 993 133 / L</b>
1 pcs M12	60 ... 6000	<b>3 842 993 134 / L</b>
1 pcs M12	110 ... 6000	<b>3 842 993 147 / L</b>
1 pcs M12	90 ... 6000	<b>3 842 993 148 / L</b>
1 pcs D17	60 ... 6000	<b>3 842 993 149 / L</b>
1 pcs D17	80 ... 6000	<b>3 842 993 150 / L</b>
1 pcs D17	80 ... 6000	<b>3 842 993 151 / L</b>
6 pcs	6070	<b>3 842 529 347</b>

Profile finishing: M12: in all core holes  
 D17: in slots A/F, B/E  
 D17V: in slots C/H, D/G

**Quick & Easy** (p. 2-8, see fold-out section)

80x80L	3 842 993 674 / ...
Length L (mm)	50 ... 6000
Standard profile finishing (note minimum length, p. 2-25)	M12 / D9,8 / D17 / DB17 / F1
Customized profile finishing (L <sub>max</sub> = 5400 mm)	DI / DIS / MT / MTS / MI / MIS / DG <sup>1)</sup>

<sup>1)</sup> DG<sub>max</sub> = 45°; L<sub>min1</sub> / L<sub>min2</sub> = 439 / 578 mm

**80x80L 4N**

A = 19,3 cm<sup>2</sup>  
 I<sub>x</sub> = 142,5 cm<sup>4</sup>  
 I<sub>y</sub> = 142,5 cm<sup>4</sup>  
 W<sub>x</sub> = 35,6 cm<sup>3</sup>  
 W<sub>y</sub> = 35,6 cm<sup>3</sup>  
 m = 5,2 kg/m

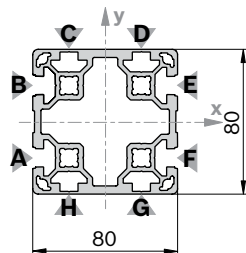

33095

Cover cap	Color	ESD		No.
80x80 (1x)	Signal gray			20 <b>3 842 548 750</b>
80x80 (1x)	Black			20 <b>3 842 548 751</b>

Material: PP

80x80L 4N	L (mm)	No.
6 pcs	6070	<b>3 842 555 651</b>

**Quick & Easy** (p. 2-8; see fold-out section)

80x80L 4N	3 842 993 769 / ...
Length L (mm)	50 ... 6000
Standard profile finishing (note minimum length, p. 2-25)	M12 / D9,8 / D17 / DB17 F1 (A, B, E, F) <sup>1)</sup>
Customized profile finishing (L <sub>max</sub> = 5400 mm)	DI / DIS / MT / MTS / MI / MIS / DG <sup>2)</sup>

<sup>1)</sup> For the specified slots

<sup>2)</sup> DG<sub>max</sub> = 45°; L<sub>min1</sub> / L<sub>min2</sub> = 439 / 578 mm

**80x80L 4NVS**

$A = 19,3 \text{ cm}^2$   
 $I_x = 142,5 \text{ cm}^4$   
 $I_y = 142,5 \text{ cm}^4$   
 $W_x = 35,6 \text{ cm}^3$   
 $W_y = 35,6 \text{ cm}^3$   
 $m = 5,2 \text{ kg/m}$

10 10  
140  
19416

Cover cap: See 80x80

**80x80L 6N**

$A = 18,8 \text{ cm}^2$   
 $I_x = 134,1 \text{ cm}^4$   
 $I_y = 140,9 \text{ cm}^4$   
 $W_x = 33,5 \text{ cm}^3$   
 $W_y = 36,2 \text{ cm}^3$   
 $m = 5,1 \text{ kg/m}$

10 10  
140  
19417

Cover cap: See 80x80

**40x120x120L**

$A = 24,6 \text{ cm}^2$   
 $I_x = 318,0 \text{ cm}^4$   
 $I_y = 318,0 \text{ cm}^4$   
 $W_x = 42,2 \text{ cm}^3$   
 $W_y = 42,2 \text{ cm}^3$   
 $m = 6,7 \text{ kg/m}$

10 10  
140  
19418

Cover cap	Color	ESD	No.
40x40 (5x)	Signal gray	100	3 842 548 746
40x80 (2x)	Signal gray	20	3 842 548 748
40x40 (1x)	Signal gray	100	3 842 548 746
40x40 (5x)	Black	⚠	20 3 842 548 747
40x80 (2x)	Black	⚠	20 3 842 548 749
40x40 (1x)	Black	⚠	20 3 842 548 747

Material: PP

**Note:**

For the 40x120x120L profile you require the following combination of cover caps: 5x 40x40 or 2x 40x80 and 1x 40x40

80x80L 4NVS		L (mm)	No.
1 pcs		50 ... 6000	3 842 993 658 / L
6 pcs		6070	3 842 538 334

Quick & Easy (p. 2-8, see fold-out section)

80x80L 4NVS	3 842 993 758 / ...
Length L (mm)	50 ... 6000
Standard profile finishing (note minimum length, p. 2-25)	M12 / D9.8 / D17 / DB17
Customized profile finishing (L <sub>max</sub> = 5400 mm)	DI / DIS / MT / MTS / MI / MIS / DG <sup>1)</sup>

<sup>1)</sup> DG<sub>max</sub> = 45°; L<sub>min1</sub> / L<sub>min2</sub> = 439 / 578 mm

80x80L 6N		L (mm)	No.
1 pcs		50 ... 6000	3 842 993 423 / L
6 pcs		6070	3 842 536 481

Quick & Easy (p. 2-8, see fold-out section)

80x80L 6N	3 842 993 675 / ...
Length L (mm)	50 ... 6000
Standard profile finishing (note minimum length, p. 2-25)	M12 / D9.8 / D17 / DB17 / F1 (A,C,F) <sup>1)</sup>
Customized profile finishing (L <sub>max</sub> = 5400 mm)	DI / DIS / MT / MTS / MI / MIS / DG <sup>2)</sup>

<sup>1)</sup> For the specified slots

<sup>2)</sup> DG<sub>max</sub> = 45°; L<sub>min1</sub> / L<sub>min2</sub> = 439 / 578 mm

40x120x120L		L (mm)	No.
1 pcs		50 ... 6000	3 842 993 653 / L
4 pcs		6070	3 842 538 287

Quick & Easy (p. 2-8, see fold-out section)

40x120x120L	3 842 993 757 / ...
Length L (mm)	50 ... 6000
Standard profile finishing (note minimum length, p. 2-25)	M12 / D9.8 (B,C,J,K) <sup>1)</sup> / D17 / DB17 (A,B,C,D,I, J,K,L) <sup>1)</sup> / F1 (D,I) <sup>1)</sup>
Customized profile finishing (L <sub>max</sub> = 5400 mm)	DI / DIS / MT / MTS / MI / MIS / DG <sup>2)</sup>

<sup>1)</sup> For the specified slots

<sup>2)</sup> DG<sub>max</sub> = 45°; L<sub>min1</sub> / L<sub>min2</sub> = 420 / 540 mm

**80x120L**

A = 25,6 cm<sup>2</sup>  
 I<sub>x</sub> = 389,2 cm<sup>4</sup>  
 I<sub>y</sub> = 192,8 cm<sup>4</sup>  
 W<sub>x</sub> = 64,9 cm<sup>3</sup>  
 W<sub>y</sub> = 48,2 cm<sup>3</sup>  
 m = 6,9 kg/m

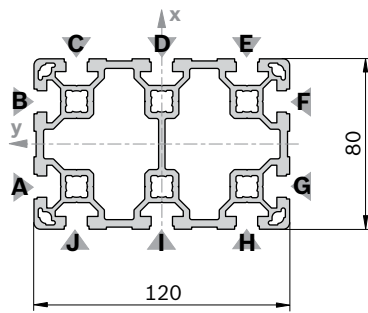

Cover cap	Color	ESD	No.
80x120 (1x)	Signal gray	20	3 842 548 792
80x120 (1x)	Black	20	3 842 548 793

Material: PP

80x120L	L (mm)	No.
1 pcs	50 ... 6000	3 842 993 201 / L
1 pcs M12	60 ... 6000	3 842 993 202 / L
1 pcs M12 M12	110 ... 6000	3 842 993 203 / L
1 pcs D17	80 ... 6000	3 842 993 204 / L
1 pcs D17V	90 ... 6000	3 842 993 229 / L
4 pcs	6070	3 842 537 828

Profile finishing: M12: in all core holes  
 D17: in slots C/J, D/I, E/H  
 D17V: in slots A/G, B/F

**Quick & Easy** (p. 2-8, see fold-out section)

80x120L	3 842 993 672 / ...
Length L (mm)	50 ... 6000
Standard profile finishing (note minimum length, p. 2-25)	M12 / D9.8 (C,D,E,H,I, J) <sup>1)</sup> / D17 (C,D,E,H,I,J) <sup>1)</sup> / DB17 / F1 (A,F) <sup>1)</sup>
Customized profile finishing (L <sub>max</sub> = 5400 mm)	DI / DIS / MT / MTS / MI / MIS / DG <sup>2)</sup>

<sup>1)</sup> For the specified slots  
<sup>2)</sup> DG<sub>max</sub> = 45°; L<sub>min1</sub> / L<sub>min2</sub> = 439 / 578 mm

**80x160L**

A = 32,9 cm<sup>2</sup>  
 I<sub>x</sub> = 850,7 cm<sup>4</sup>  
 I<sub>y</sub> = 253,4 cm<sup>4</sup>  
 W<sub>x</sub> = 106,3 cm<sup>3</sup>  
 W<sub>y</sub> = 63,4 cm<sup>3</sup>  
 m = 8,9 kg/m

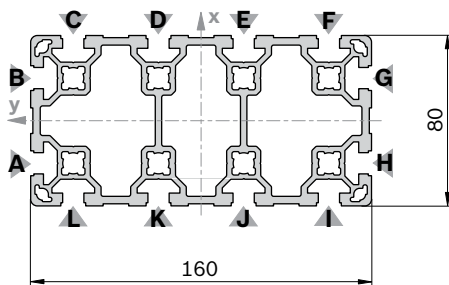

Cover cap	Color	ESD	No.
80x80 (2x)	Signal gray	20	3 842 548 750
80x80 (2x)	Black	20	3 842 548 751

Material: PP

80x160L	L (mm)	No.
1 pcs	50 ... 6000	3 842 993 127 / L
1 pcs M12	60 ... 6000	3 842 993 128 / L
1 pcs M12 M12	110 ... 6000	3 842 993 152 / L
1 pcs M12 D17	90 ... 6000	3 842 993 153 / L
1 pcs D17	60 ... 6000	3 842 993 154 / L
1 pcs D17	80 ... 6000	3 842 993 155 / L
1 pcs D17V	90 ... 6000	3 842 993 226 / L
3 pcs	6070	3 842 529 349

Profile finishing: M12: in all core holes  
 D17: in slots C/L, D/K, E/J, F/I  
 D17V: in slots A/H, B/G

**Quick & Easy** (p. 2-8, see fold-out section)

80x160L	3 842 993 673 / ...
Length L (mm)	80 ... 6000
Standard profile finishing (note minimum length, p. 2-25)	M12 / D9.8 (C,D,E,F,I, J,K,L) <sup>1)</sup> / D17 (C,D,E,F,I,J, K,L) <sup>1)</sup> / DB17 / F1 (A,G) <sup>1)</sup>
Customized profile finishing (L <sub>max</sub> = 5400 mm)	DI / DIS / MT / MTS / MI / MIS / DG <sup>2)</sup>

<sup>1)</sup> For the specified slots  
<sup>2)</sup> DG<sub>max</sub> = 45°; L<sub>min1</sub> / L<sub>min2</sub> = 460 / 620 mm